

# Welcome to the AccessibilityOnline Webinar Series



A collaborative program between the ADA National Network and the U.S. Access Board



The Session is Scheduled to begin at 2:30pm Eastern Time  
We will be testing sound quality periodically

Audio and Visual are provided through the on-line webinar system. This session is closed captioned. Individuals may also listen via telephone by dialing 712-432-3100 code 930098 # (This is not a Toll Free number)

The content and materials of this training are property of the US Access Board and the Great Lakes ADA Center and cannot be used and/or distributed without permission. This program is funded through a contract agreement with the U.S. Access Board. For permission to use training content or obtain copies of materials used as part of this program please contact us by email at [adata@adagreatlakes.org](mailto:adata@adagreatlakes.org) or toll free (877)232-1990 (V/TTY)

[www.AccessibilityOnline.org](http://www.AccessibilityOnline.org)

---

---

---

---

---

---

---

---



## Webinar Features

- **Closed captioning** – click **CC** icon (located in the Audio/Video Panel) or control-F8 (command-F8) and adjust your screen.
- **Questions** – Highlight “GreatLakes” in the participant list and “right click” on your mouse to send a private message. Type your message into the chat area that appears. The question will be viewed by all moderators. (Keyboard - F6, Arrow up or down to locate “GreatLakes” and select to send a message )

2

---

---

---

---

---

---

---

---



## Webinar Features (con't)

- **Customize your view** – You can change the size and location of any of the panels (Chat, etc.) by hovering your mouse over the ☰ icon at the right of each panel and select “Detach Panel”. Each panel can be repositioned and resized.

3

---

---

---

---

---

---

---

---



## Webinar Features (con't)

- **Resize the Whiteboard (where PowerPoint slides are shown):** It can be resized using the drop down located in the Whiteboard area. (The default is "Fit Size").
- **Emotions:** Please refrain from using the emoticons, hand-raising and polling features during this session unless directed to do so by the presenter.

4

---

---

---

---

---

---

---

---



## Presenter



**Earlene Sesker**

5

---

---

---

---

---

---

---

---



## Proposed Guidelines for Medical Diagnostic Equipment

### *Session Agenda*

- **Background**
- **Organization of Proposed Rule**
- **Proposed Technical Criteria**
- **Major Issues**
- **Next Steps**

6

---

---

---

---

---

---

---

---

## Background

- Section 4203 of Patient Protection and Affordable Care Act (Public Law 111-148, 124 Stat. L. 119)
- Section 510 of the Rehabilitation Act of 1973

UNITED STATES ACCESS BOARD

7

---

---

---

---

---

---

---

---

## Federal Partners



- U.S. Food and Drug Administration, Department of Health and Human Services
- Disability Rights Section, Department of Justice
- Department of Veterans Affairs

UNITED STATES ACCESS BOARD

8

---

---

---

---

---

---

---

---

## Barriers Affecting Accessibility and Usability of Medical Diagnostic Equipment

- 75% - examination tables moderately difficult to impossible to use
- 68% - radiology equipment moderately difficult to impossible to use
- 53% - weight scales moderately difficult to impossible to use
- 50% - examination chairs moderately difficult to impossible to use

Rehabilitation Engineering Research Center on Accessible Medical Instrumentation 2004 national Survey

9

---

---

---

---

---

---

---

---

## Background

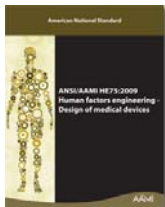

- **ANSI/AAMI HE75 – 2009 Human Factors Engineering – Design of Medical Devices**
- **Chapter 16 – Accessibility Considerations**

UNITED STATES ACCESS BOARD

10

---

---

---

---

---

---

---

---

## Background

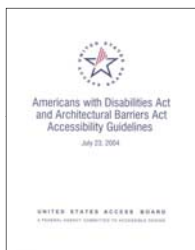

### ADA and ABA Accessibility Guidelines

UNITED STATES ACCESS BOARD

11

---

---

---

---

---

---

---

---

## How The Rule is Organized

- **Preamble**
- **Regulatory Analysis**
- **Text of the Proposed Rule**

UNITED STATES ACCESS BOARD

12

---

---

---

---

---

---

---

---

## How The Rule is Organized

---

- M1 Application and Administration
- M2 Scoping Requirements
- M3 Technical Criteria
  - Supine, Prone, or Side Lying Position
  - Seated Position
  - Seated in Wheelchair
  - Standing Position
  - Communication
  - Operable Parts

UNITED STATES ACCESS BOARD

13

---

---

---

---

---

---

---

---

## Definitions

---

**Enforcing Authority** – An agency that adopts the standards as mandatory requirements for entities subject to its jurisdiction.

**Medical Diagnostic Equipment** – Equipment used in or in conjunction with medical settings by health care providers for diagnostics purposes.

UNITED STATES ACCESS BOARD

14

---

---

---

---

---

---

---

---

## Definitions

---

**Operable Parts** – A component of diagnostics equipment that is used by the patient to activate, deactivate, or adjust the equipment.

**Transfer Surface** – Part of diagnostic equipment onto which patients who use mobility devices or aids transfer when moving onto and off of the equipment.

UNITED STATES ACCESS BOARD

15

---

---

---

---

---

---

---

---

## Supine, Prone, or Side-Lying



UNITED STATES ACCESS BOARD

16

---

---

---

---

---

---

---

---

## Supine, Prone, or Side-Lying Position

- Transfer Surface
- Supports
- Lift Compatibility

UNITED STATES ACCESS BOARD

17

---

---

---

---

---

---

---

---

## Supine, Prone, or Side-Lying Position

### Transfer Surface:

- Height
- Size
- Transfer Sides



UNITED STATES ACCESS BOARD

18

---

---

---

---

---

---

---

---

## Supine, Prone, or Side-Lying Position

### Supports

- Transfer Supports
- Stirrups
- Head and Back Support



UNITED STATES ACCESS BOARD

19

---

---

---

---

---

---

---

---

## Lift Compatibility



UNITED STATES ACCESS BOARD

20

---

---

---

---

---

---

---

---

## Lift Compatibility

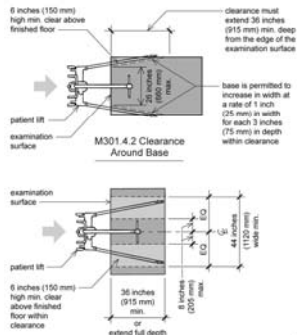

21

---

---

---

---

---

---

---

---

## Seated Position



UNITED STATES ACCESS BOARD

22

---

---

---

---

---

---

---

---

## Seated Position

- Transfer Surface
- Supports
- Lift Compatibility



UNITED STATES ACCESS BOARD

23

---

---

---

---

---

---

---

---

## Lift Compatibility Exception

Where diagnostic equipment meets the requirements of M303 (seated in a wheelchair) and provides a folding seat, the equipment shall not be required to comply with the lift compatibility provisions.



UNITED STATES ACCESS BOARD

24

---

---

---

---

---

---

---

---



## Seated in a Wheelchair

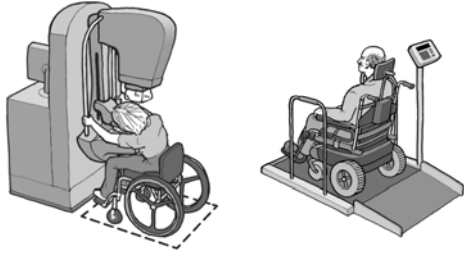

UNITED STATES ACCESS BOARD

25

---

---

---

---

---

---

---

---

## Seated in a Wheelchair

- Wheelchair Spaces
- Entry
- Components

UNITED STATES ACCESS BOARD

26

---

---

---

---

---

---

---

---

## Seated in a Wheelchair

### Wheelchair Spaces:

- Orientation
- Width
- Depth
- Knee Clearance
- Toe Clearance



UNITED STATES ACCESS BOARD

27

---

---

---

---

---

---

---

---

## Seated in a Wheelchair

Entry:

- Vertical
- Beveled
- Ramped



UNITED STATES ACCESS BOARD

28

---

---

---

---

---

---

---

---

## Seated in a Wheelchair Components



UNITED STATES ACCESS BOARD

29

---

---

---

---

---

---

---

---

## Seated in a Wheelchair Components

Height of the breast platform = 30 inches minimum and 42 inches high maximum when in use by a patient seated in a wheelchair.



UNITED STATES ACCESS BOARD

30

---

---

---

---

---

---

---

---

## Standing

- Standing Surface
- Standing Supports



UNITED STATES ACCESS BOARD

31

---

---

---

---

---

---

---

---

## Supports

- Transfer
- Standing



UNITED STATES ACCESS BOARD

32

---

---

---

---

---

---

---

---

## Technical Criteria Across Equipment Types

- Communication
- Operable Parts

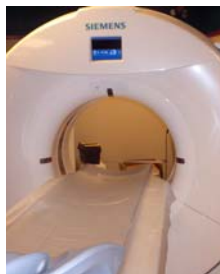

UNITED STATES ACCESS BOARD

33

---

---

---

---

---

---

---

---

## Example Application Document

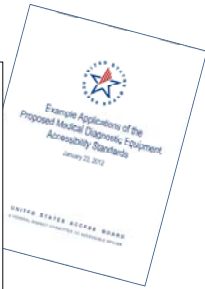

34

---

---

---

---

---

---

---

---

## Responses to NPRM

- 46 questions were posed in the preamble
- 51 commenters
- Range of comments

UNITED STATES ACCESS BOARD

35

---

---

---

---

---

---

---

---

## Major Issues

- Transfer Surface Size and Height
- Transfer Surface Obstructions
- Transfer Support Location and Configuration
- Depth of Wheelchair Spaces

UNITED STATES ACCESS BOARD

36

---

---

---

---

---

---

---

---

## Transfer Surface Height

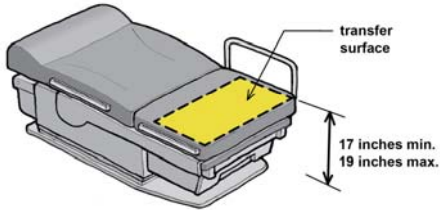

37

---

---

---

---

---

---

---

---

## Transfer Surface Height

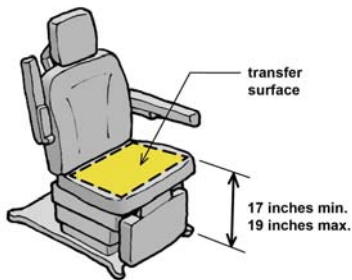

38

---

---

---

---

---

---

---

---

## Transfer Surface Height

### Question 14

#### Adjustable Height

- a) Types of equipment currently height adjustable?
- b) Types of equipment not height adjustable?
- c) Equipment that can not be height adjustable?
- d) Intermediate heights?

39

---

---

---

---

---

---

---

---

## Transfer Surface Height

---

### Patients

- Height is a major concern
- Range of users accommodated

UNITED STATES ACCESS BOARD

40

---

---

---

---

---

---

---

---

## Transfer Surface Height

---

### Manufacturers

- Seat profile
- Components beneath transfer surface
- Span between the lowest transfer height and optimal caregiver height
- Cost and redesign

41

---

---

---

---

---

---

---

---

## Transfer Surface Height



### Equipment Design Concerns

42

---

---

---

---

---

---

---

---

## Transfer Surface Size

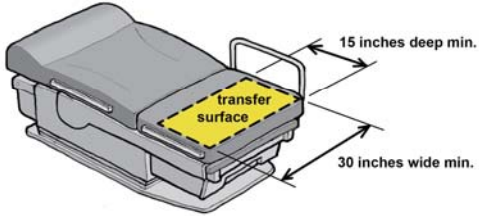

43

---

---

---

---

---

---

---

---

## Transfer Surface Size

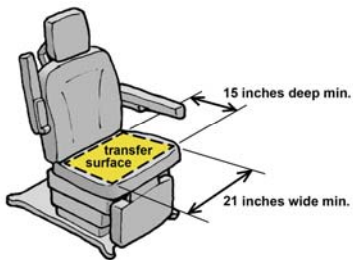

44

---

---

---

---

---

---

---

---

## Transfer Surface Size

### Question 15

#### Supine, Prone, or Side-Lying Position

- a) Is proposed size sufficient? (30" by 15")
- b) Support surface width  $\geq$  transfer surface?
- c) Alternate dimensions?
- d) Permit expandable surface (e.g., extendable platform)
- e) If required to be provided at more than one location where should transfer surface be located?

45

---

---

---

---

---

---

---

---

**Transfer Surface Size**

---

**Question 16**

**Seated Position:**

a) Is proposed size sufficient?

b) Alternate dimensions? (21" wide and 15" deep)



46

---

---

---

---

---

---

---

---

**Response to NPRM Questions**

---

**Patients**

- Space for transfer
- Repositioning after transfers
- Range of body sizes
- Ergonomics

UNITED STATES ACCESS BOARD

47

---

---

---

---

---

---

---

---

**Response to NPRM Questions**

---

**Manufacturers**

- Use of supports
- Corner shape on transfer sides
- Relationship to base design
- Equipment proportions
- Redesign and costs
- Impact on exam room layouts

48

---

---

---

---

---

---

---

---



## Transfer Surface Size

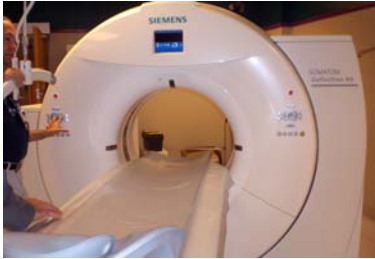

### Equipment Design Concerns

49

---

---

---

---

---

---

---

---

## Transfer Surface Size

### Diagnostic Equipment Used by Patients in Supine, Prone, or Side-Lying Position

- Width: increase to 35 to 36 inches  
decrease to 25 to 28 inches
- Same requirement for Equipment  
Used by Patients in Seated Position

UNITED STATES ACCESS BOARD

50

---

---

---

---

---

---

---

---

## Transfer Surface Size

### Diagnostic Equipment Used by Patients in in Seated Position

- Alternate dimensions – 17 inches  
minimum depth
- Relationship to size requirement

UNITED STATES ACCESS BOARD

51

---

---

---

---

---

---

---

---

## Permitted Obstructions to the Transfer Surface



Same issue for equipment used by patients in a supine, prone, or side-lying and equipment used in a seated position

52

---

---

---

---

---

---

---

---

## Transfer Sides

**Transfer Sides** - Located to provide options to transfer from a mobility device onto one short side (depth) and one long side (width) of the surface. Each transfer side to provide unobstructed access to the transfer surface.

**EXCEPTION:** Temporary obstructions shall be permitted provided that they can be repositioned to permit transfer.

53

---

---

---

---

---

---

---

---

## Permitted Obstructions

### Question 17

#### Transfer Sides:

- a) 3 inches maximum extension beyond the edge of the transfer sides
- b) Redesign requirements



54

---

---

---

---

---

---

---

---

## Permitted Obstructions

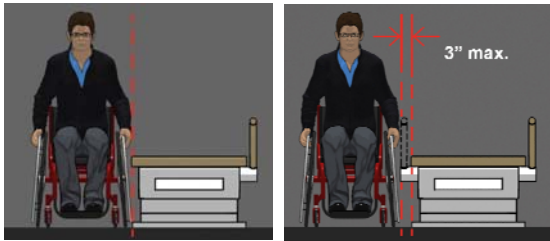

Permit Up to 3 Inch Gap?

UNITED STATES ACCESS BOARD

55

---

---

---

---

---

---

---

---

## Permitted Obstructions



Equipment Components That Extend Beyond Exam Surface

56

---

---

---

---

---

---

---

---

## Permitted Obstructions

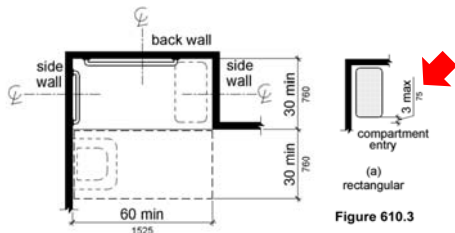

Figure 608.2.2

Shower seat edge is permitted to be 3 inches max. from shower entry

57

---

---

---

---

---

---

---

---

## Response to NPRM Questions

### Patient Use – If Gap is Permitted

- Concerns about safety of transfers across a gap to exam surface
- Patient may not be in optimal health
- Equipment parts that extend beyond surface should not be permanently mounted

UNITED STATES ACCESS BOARD

58

---

---

---

---

---

---

---

---

## Response to NPRM Questions

### Equipment – If Gap is Not Permitted

- Need to add accessories
- Impact on certain equipment types – beds/stretchers and imaging
- Capacity of supports to bear weight loads if removable
- Redesign likely and associated cost

UNITED STATES ACCESS BOARD

59

---

---

---

---

---

---

---

---

## Transfer Research



set up reflects  
amusement ride  
focus

Study: The Impact of  
Transfer Setup on the  
Performance of  
Independent Wheelchair  
Transfers

120 Subjects capable of  
independent transfer

Variety of configurations  
tested – including distance  
from seat

60

---

---

---

---

---

---

---

---

## Transfer Research



Height adjusted and spacers added at floor level

61

---

---

---

---

---

---

---

---

## Transfer Support Location and Configuration



62

---

---

---

---

---

---

---

---

## Transfer Support Location and Configuration

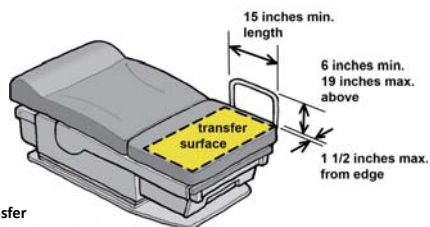

At least one transfer support provided on the side of the transfer surface (recommended on each side)

UNITED STATES ACCESS BOARD

63

---

---

---

---

---

---

---

---

## Transfer Support Location and Configuration

### Question 19

- a) Is proposed criteria sufficient?
- b) Can supports on different types of equipment meet proposed criteria?
- c) Redesign costs?
- d) Alternate technical criteria?
- e) Permit angled or vertical supports?

UNITED STATES ACCESS BOARD

64

---

---

---

---

---

---

---

---

## Transfer Support Location and Configuration

### Question 20

Height:

- a) Considering 6 min. and 19 max. above surface. Is height this range usable?
- b) Can supports on different types of equipment meet proposed criteria?
- c) Alternate criteria?

UNITED STATES ACCESS BOARD

65

---

---

---

---

---

---

---

---

## Proposed Gripping Surface Cross Section

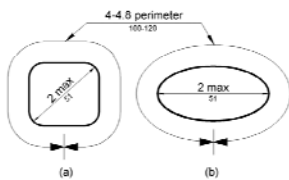

Non-circular Cross Section

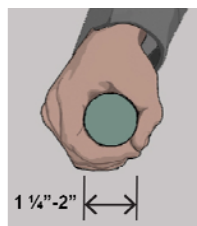

Circular Cross Section

UNITED STATES ACCESS BOARD

66

---

---

---

---

---

---

---

---

## Armrest on Exam Chairs



UNITED STATES ACCESS BOARD

67

---

---

---

---

---

---

---

---

## Transfer Support Location and Configuration

### Question 21

Cross Section of Gripping Surface:

- a) Can transfer support meet grab bar specifications in ADA Standard?
- b) Can handholds meeting cross section be integrated in cushioned armrest?
- c) Alternate designs?

UNITED STATES ACCESS BOARD

68

---

---

---

---

---

---

---

---

## Proposed Gripping Surface Clearance

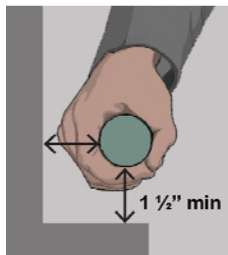

UNITED STATES ACCESS BOARD

69

---

---

---

---

---

---

---

---

## Transfer Support Location and Configuration

### Question 22

**Clearance Around Gripping Surfaces:**  
Can transfer supports on different types of equipment provide 1 ½ inches minimum clearance around the gripping surfaces?

UNITED STATES ACCESS BOARD

70

---

---

---

---

---

---

---

---

## Depth of Wheelchair Spaces

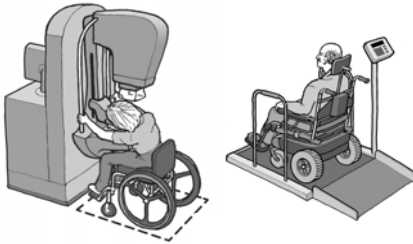

M303 Diagnostic Equipment Used by Patients Seated in a Wheelchair

UNITED STATES ACCESS BOARD

71

---

---

---

---

---

---

---

---

## Depth of Wheelchair Spaces

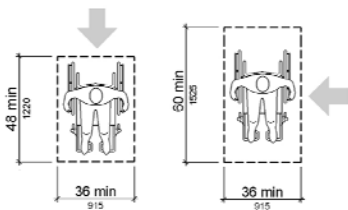

**front or rear**      **side**  
Wheelchair Spaces – Width and Depth

UNITED STATES ACCESS BOARD

72

---

---

---

---

---

---

---

---



### Depth of Wheelchair Spaces

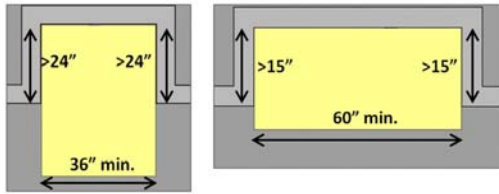

Based on 305.7 Maneuvering Clearances where space confined on 3 sides (and more than half of space depth confined)

UNITED STATES ACCESS BOARD

73

---

---

---

---

---

---

---

---

### Depth of Wheelchair Spaces

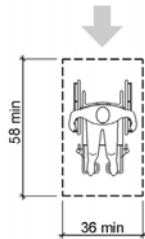
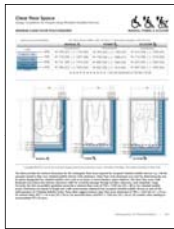

data from wheeled mobility anthropometry project indicates a 58 inch width minimum for front or rear entry

74

---

---

---

---

---

---

---

---

### Depth of Wheelchair Spaces

#### Question 29

- a) What would be the incremental costs for the design or redesign and manufacture of the equipment to provide a wheelchair space that is 58 inches deep minimum?
- b) Are there types of equipment that cannot provide a wheelchair space that is 58 inches deep min. because of the structural or operational characteristics of the equipment?

UNITED STATES ACCESS BOARD

75

---

---

---

---

---

---

---

---

## Depth of Wheelchair Spaces

edge protection – some curbs permit wheelchair footrests to extend beyond the raised platform

Exceptions Considered if edge protection permits:

- 32" width minimum, 36" would be needed for arms and elbows
- 48" depth minimum

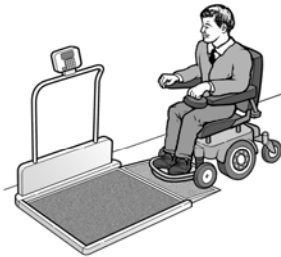

Wheelchair Spaces on Raised Platform

76

---

---

---

---

---

---

---

---

## Depth of Wheelchair Spaces

### Question 31

- How much of 48 min. depth of wheelchair space should be permitted to extend beyond raised platform edge and over edge protection?
- Maximum height of edge protection to allow extension beyond platform over edge protection?
- Should supports be prohibited from obstructing wheelchair space outside the perimeter of the raised platform above any edge protection?

UNITED STATES ACCESS BOARD

77

---

---

---

---

---

---

---

---

## Depth of Wheelchair Spaces

### Question 32

- Raised platforms usable by patients who use scooters?
- Should width and depth be changed to accommodate scooters?
- Should folding seats be required on raised platforms?
- If folding seat provided should platform be able to accommodate scooters?



78

---

---

---

---

---

---

---

---

## Next Steps

- **Comment Analysis**
- **Advisory Committee**
- **Final Rule**

UNITED STATES ACCESS BOARD

79

---

---

---

---

---

---

---

---

## Questions?

Highlight "GreatLakes" in the participant list and "right click" on your mouse to send a private message. Type your message into the chat area that appears. The question will be viewed by all moderators. (Keyboard - F6, Arrow up or down to locate "GreatLakes" and select to send a message )

80

---

---

---

---

---

---

---

---



## U.S. Access Board

**(800) 872-2253 (voice)**

**(800) 993-2822 (TTY)**

**E-mail: [ta@access-board.gov](mailto:ta@access-board.gov)**

**[www.access-board.gov](http://www.access-board.gov)**

UNITED STATES ACCESS BOARD

81

---

---

---

---

---

---

---

---

**Thank you for participating  
in today's webinar**



**Next scheduled session:  
"Accessible Amusement Rides"  
January 3, 2013**

[www.AccessibilityOnline.org](http://www.AccessibilityOnline.org)

877-232-1990 (V/TTY) <sup>82</sup>

---

---

---

---

---

---

---

---